



## IMB-Series Basket Strainers

Designed for inorganic contaminants removal



Rain Bird IMB-Series Basket Strainers are a low-cost filter solution designed to be used for the removal of inorganic contaminants. IMB Strainers trap gross contaminants and are able to withstand a substantial amount of loading without failure. When used as a secondary filter the basket strainer is intended to capture contaminants that may enter the system as a result of a pipeline break or system malfunction.

### Applications

- Removal of sand, rock, grit and other inorganic contaminants to protect drip and micro-irrigation systems with fine mesh filtration down to 200 mesh (75 microns)
- 80 psi standard operating pressure (high pressure systems available)
- Flow ranges from 110 gpm and up

- Can be used as a primary filter in specific applications
- Can be used as a secondary filter to a sand media filter, centrifugal separator or other primary filtration system

### Advantages

- Rugged, field changeable, washable and replaceable polypropylene filter mesh sock available in 80, 100, 150, and 200 mesh
- Easy-entry lid closure
- Available in welded carbon steel
- 3M Scotchkote® 134 fusion bonded epoxy coating on interior surfaces
- Exterior of housing is coated with UV stabilized polyester powder coat for longer product life and greater protection from the environment

### Standard assembly includes:

- Carbon steel housing
- Easy-entry lid closure
- 3M Scotchkote® 134 fusion bonded epoxy coating on interior surfaces
- Polyester powder coating on exterior surfaces
- Internal stainless steel basket with field replaceable filter mesh
- 3-way valve
- Pressure gauge
- Tubing with fittings
- Drain valve

### Available options:

- ASME code
- High pressure
- Grooved or flanged mainline connections
- Available in purple for reclaim water applications

INDUSTRIAL & MUNICIPAL

## IBS-Series Filter Specifications

Model	Maximum Flow		Filtration Surface Area (total sq ft)	Maximum Pressure (psi)	Inlet/Outlet (in)	Dimensions				
	gpm	m <sup>3</sup> /hr				A	B	C	D	E
IMB-S2	110	25	0.44	150 psi	2"	13 5/8"	3 1/8"	4 3/4"	11 5/8"	11"
IMB-S3	250	57	1.01	150 psi	3"	18 1/8"	5 1/4"	6 1/4"	12 1/2"	13"
IMB-S4	355	81	1.01	150 psi	4"	18 1/8"	5 1/4"	6 1/4"	12 1/2"	13"
IMB-S6	950	216	2.96	80 psi	6"	30 5/8"	8 1/4"	14 1/4"	18 3/4"	15 7/8"
IMB-S8	1250	284	2.57	80 psi	8"	31 5/8"	10 3/4"	12 1/4"	20 3/4"	18 1/8"
IMB-S10	1875	426	5.59	80 psi	10"	41 7/8"	15"	16 1/2"	24"	19 3/4"

Contact Rain Bird for drawings or visit [industrial.rainbird.com](http://industrial.rainbird.com) to download.

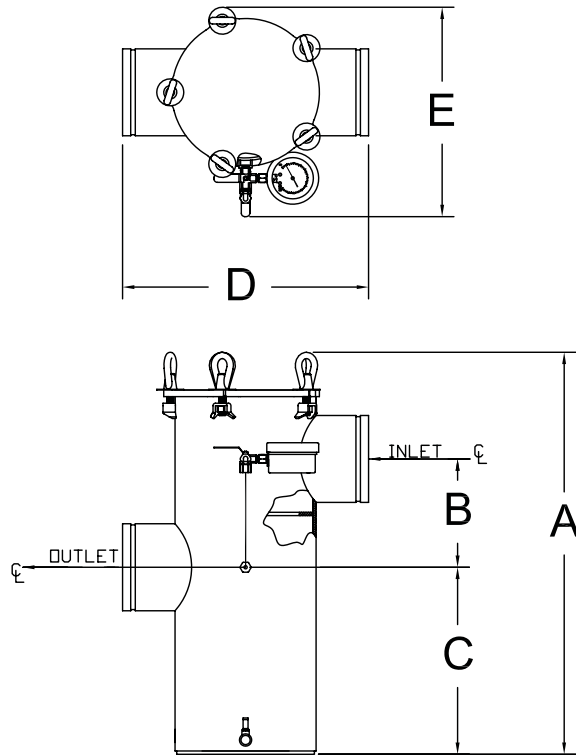

**Rain Bird Corporation**  
6991 E. Southpoint Road  
Tucson, AZ 85756  
Phone: (520) 741-6523  
Fax: (520) 806-5678

**Rain Bird Corporation**  
970 West Sierra Madre Avenue  
Azusa, CA 91702

**Rain Bird International, Inc.**  
1000 West Sierra Madre Ave.  
Azusa, CA 91702

[www.rainbird.com](http://www.rainbird.com)

The Intelligent Use of Water™